

APPENDIX 14



Island  
Development  
Committee

South Hill, St. Helier,  
Jersey JE2 4US.  
Telephone (0534) 25511  
Fax Line (0534) 68952

COPY

ISLAND PLANNING (JERSEY) LAW, 1964.  
PUBLIC HEALTH (CONTROL OF BUILDING)  
(JERSEY) LAW, 1956.

Registration No. 3199/IA

To:

Retreat Farm (1988) Ltd.  
Retreat Farm  
La Rue de la Frontiere  
St. Lawrence

The Island Development Committee, having considered your [agent's] application hereby  
GRANTS PERMISSION in respect of the following development :-

Landscaping of field 78 to form over-spill parking facilities for visitors  
proposed to be carried out at :-

Retreat Farm, La Rue de la Frontiere, St. Lawrence

in accordance with the plan(s) accompanying the said application, subject to compliance  
with the following conditions.

1. That the whole of the approved work shown on the plan(s) accompanying the said  
application shall be completed by 1st October 1994.
2. That the accompanying notices required under the Building Bye-Laws are submitted at the  
appropriate stages of development, as indicated in the heading of each notice, and that  
no part of the development is brought into use until it has been inspected and passed  
by a duly authorised officer of the Committee.
3. That the development shall commence within one year of the date of this permit, which  
shall otherwise cease to be valid.
4. That the existing conifers on the roadside boundary of La Rue Des Varvots are to be  
retained as part of the landscaping proposals and shall not be lopped topped or felled  
without the prior consent of the Island Development Committee.

The following approved plan(s) is/are enclosed:

HC, IC.

Date: 1st October 1992

Signed:  WORK for Director.

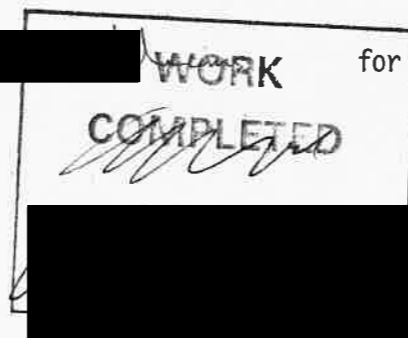

**CAUTION**

The grant of this consent is purely permissive and in no way absolves the parties concerned from obtaining, nor does it overrule, any other permission that may be required under the Regulation of Undertakings and Development, Tourism, Lodging House, Licensing, Health & Safety, Public Health, Fire Precaution or other relevant Laws and regulations, including all those administered by the Housing, Agriculture and Fisheries, Tourism, Public Health and Social Security Committees. In addition, this consent does not overrule any private property restriction affecting the land

DW

731  
ISLAND DEVELOPMENT COMMISSION  
JERSEY  
THIS IS THE PLAN REFERRED TO IN  
PLANNING / DEVELOPMENT

PERMIT No. 3199

APPROVED ON  
1 OCT 1992

SUBJECT TO THE  
CONDITIONS  
ENDORSED ON  
THE PERMIT

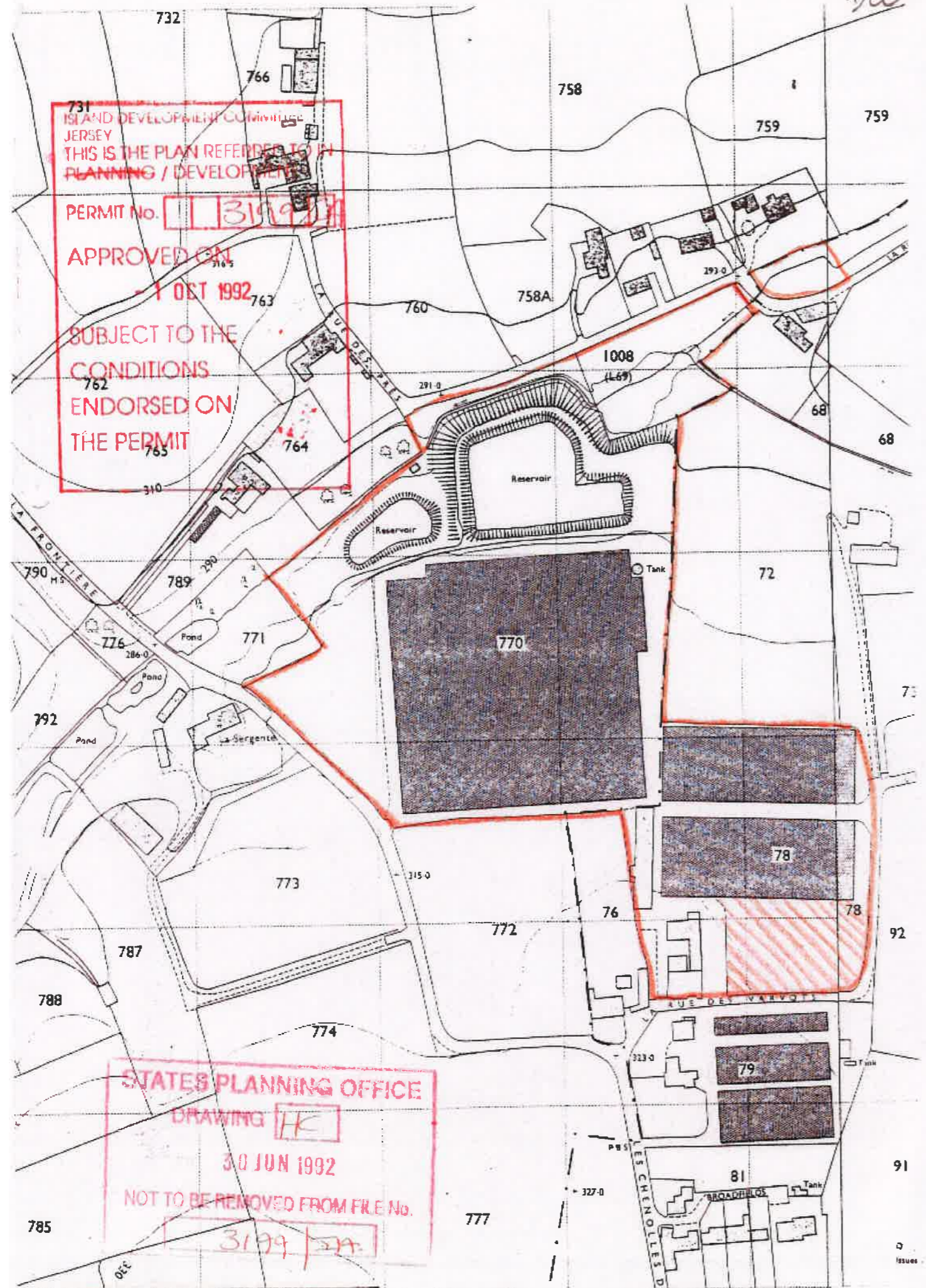

STATES PLANNING OFFICE

DRAWING HK

30 JUN 1992

NOT TO BE REMOVED FROM FILE No.

3199/271

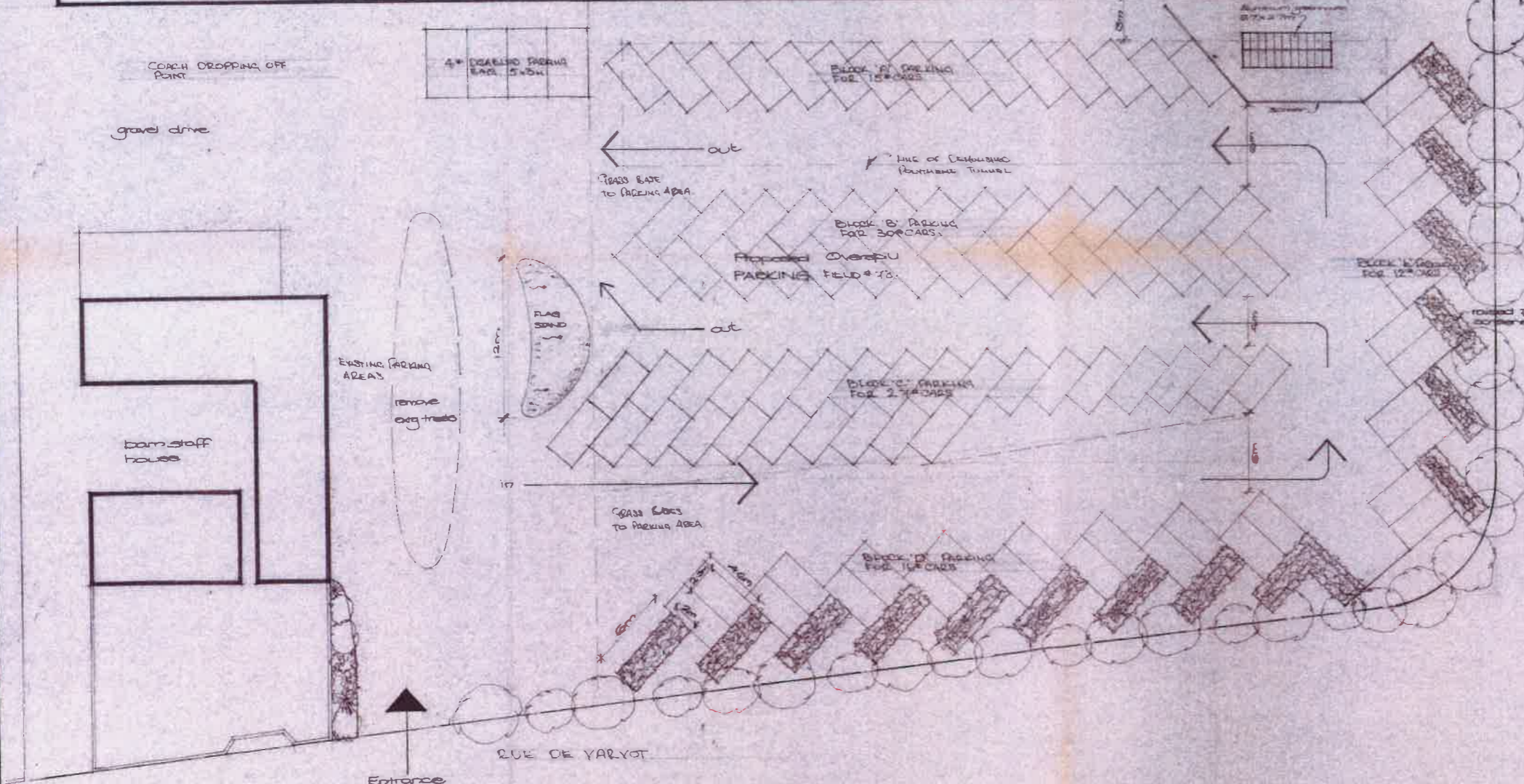
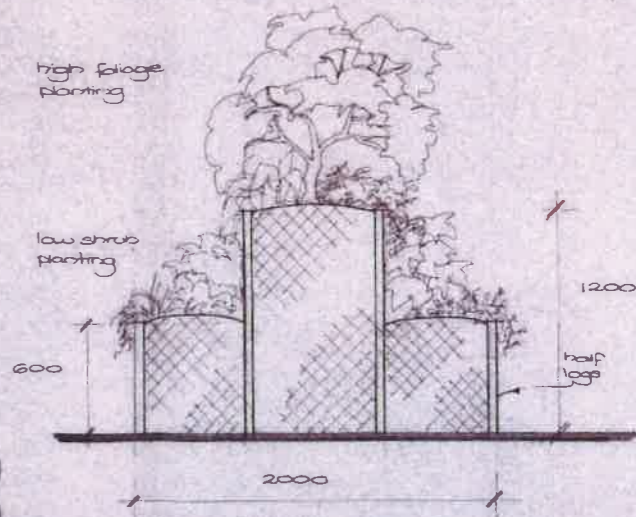
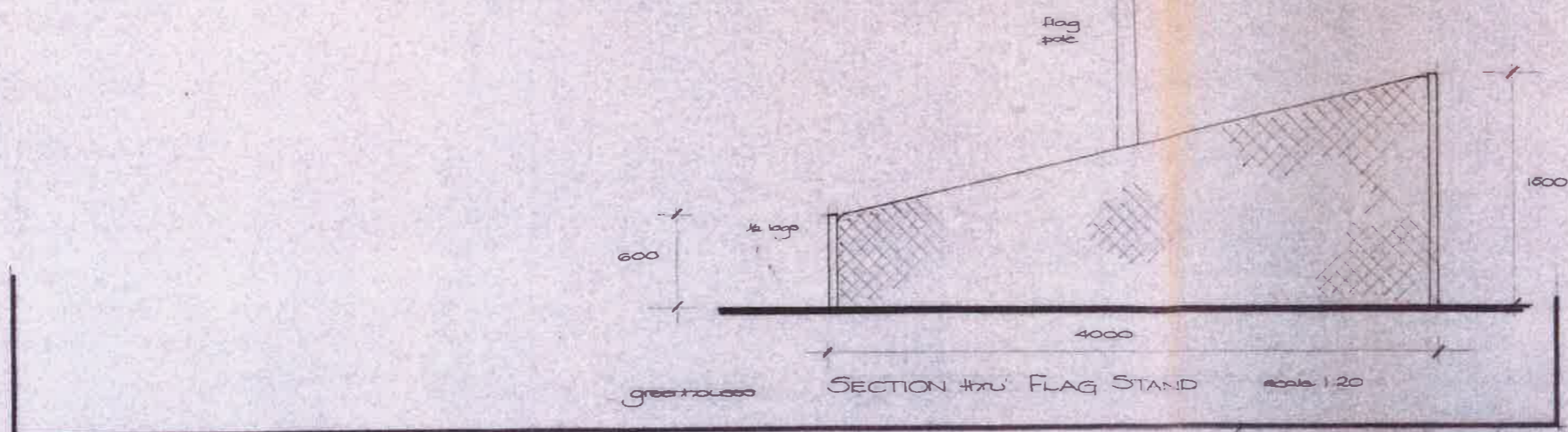

THIS IS THE PLAN REFERRED TO IN  
 PLANNING / DEVELOPMENT  
 PERMIT No. **13647**  
 APPROVED ON  
 - 1 OCT 1992  
 SUBJECT TO THE  
 CONDITIONS  
 ENDORSED ON  
 THE PERMIT

These drawings form part of the Register of  
 Planning and Building Applications. They are  
 protected by copyright under the  
 Intellectual Property (Enforcement) (Jersey)  
 Law 2011 (Article 70 of the 2011 Law).  
 This material is being provided to you  
 for public inspection the Register  
 and must not be used for other purposes without the  
 prior permission of the copyright owner.

**roger norman**  
**design consultants**

Second Floor Suite, 9 New St., St. Helier, Jersey, Channel Isles.

tel:- 0534 37620  
 fax:- 0534 37619

**notes:-**  
 Do not scale. DESIGN COPYRIGHT  
 Check all dimensions on site.  
 This drawing to be read in conjunction with approved specification, engineers and sub contractors drawings.  
 Any discrepancies between drawings, specifications and details to be referred to Roger Norman Design Consultants  
 before any work is carried out. All work carried out must comply with Building Byelaws (Jersey).

amendments	date	drawn
A ISSUED FOR CLIENT APPROVAL	26.1.92	RN
B RAISED FOR 10% APPROVAL WITH (2043)	26.1.92	RN
C		
D		
E		
F		
G		

details	scale	date	drg. no	drawn
Proposed CAR PARK (P04)	1:200	01.92	714/00	SP
RETREAT FARM, Rue de la Forbiere St. Lawrence.	1:20		A B C D E F G H I	