

Building Application No. DS/2018/0080/

DANGEROUS BUILDING NOTICE

PLANNING AND BUILDING (JERSEY) LAW 2002

- 1. This Notice** is issued pursuant to the powers conferred under Article 66 of the Planning and Building (Jersey) Law 2002 because it appears that the building identified below is in a dangerous condition, or is being used to carry a load or in a manner that makes it dangerous.

This Notice relates to the building within the rear yard of a property known as: **Santa Maria** which is situated at **16 Columbus Street, St. Helier JE2 3YL**, shown edged by a bold black line on the attached plan.

- 2. The matter(s) which appears to make the building dangerous:**
 - The roof rafters and first floor joists are exposed to the elements and are in a state of decay causing the east facing external wall of the building to be pushed outwards.
 - A section of the wall supporting the roof is severely bowed and presents a significant risk of collapse.
 - There are signs of movement in the walls supporting the roof which could result in the stability of the building becoming a risk to the neighbouring buildings.
 - There is a section of roof tiles which are in poor condition and loosely fixed which present a potential safety risk to people near to the building.
- 3. The reason for serving this Notice:** The overall condition of the building is in a state of neglect and disrepair and presents a significant risk of structural failure that could impact on the health and safety of people in the vicinity of the building.
- 4. You are hereby required to:**
 - Remove all roof tiles on the west facing elevation.
 - Remove all exposed roof rafters from the building.
 - Demolish the east facing external façade down to first floor level.
 - Demolish the south facing gable end wall to 300mm above the roofline of the adjacent building, and weather-proof the top of the remaining masonry wall.
- 5. Period of compliance:** 28 days after the issue of this Notice.

Department of the Environment

Building Control

South Hill

St Helier, Jersey, JE2 4US

Tel: +44 (0)1534 445508



6. **What will happen if this Notice is not complied with:** If you fail to comply with this Notice, you may be liable to prosecution under the appropriate Article of the Planning and Building (Jersey) Law 2002 for failure to comply with a Dangerous Building Notice.
7. **Your rights of appeal:** In accordance with Article 109 of the above Law, you may appeal against the Notice, in writing to the Greffier no later than the end of the period of 28 days beginning with the date of issue of the Notice. The date of the issue of the Notice shall be taken as the date stated below.

SIGNED:  on this Date: Thursday 08/02/18

NAME: David Hallam
For and on behalf of the Chief Officer

THIS IS THE BUILDING
TO WHICH THIS
NOTIC REFERS
TO AT THE REAR
OF N° 16
COLUMBUS
STREET.
DS/2018/0080

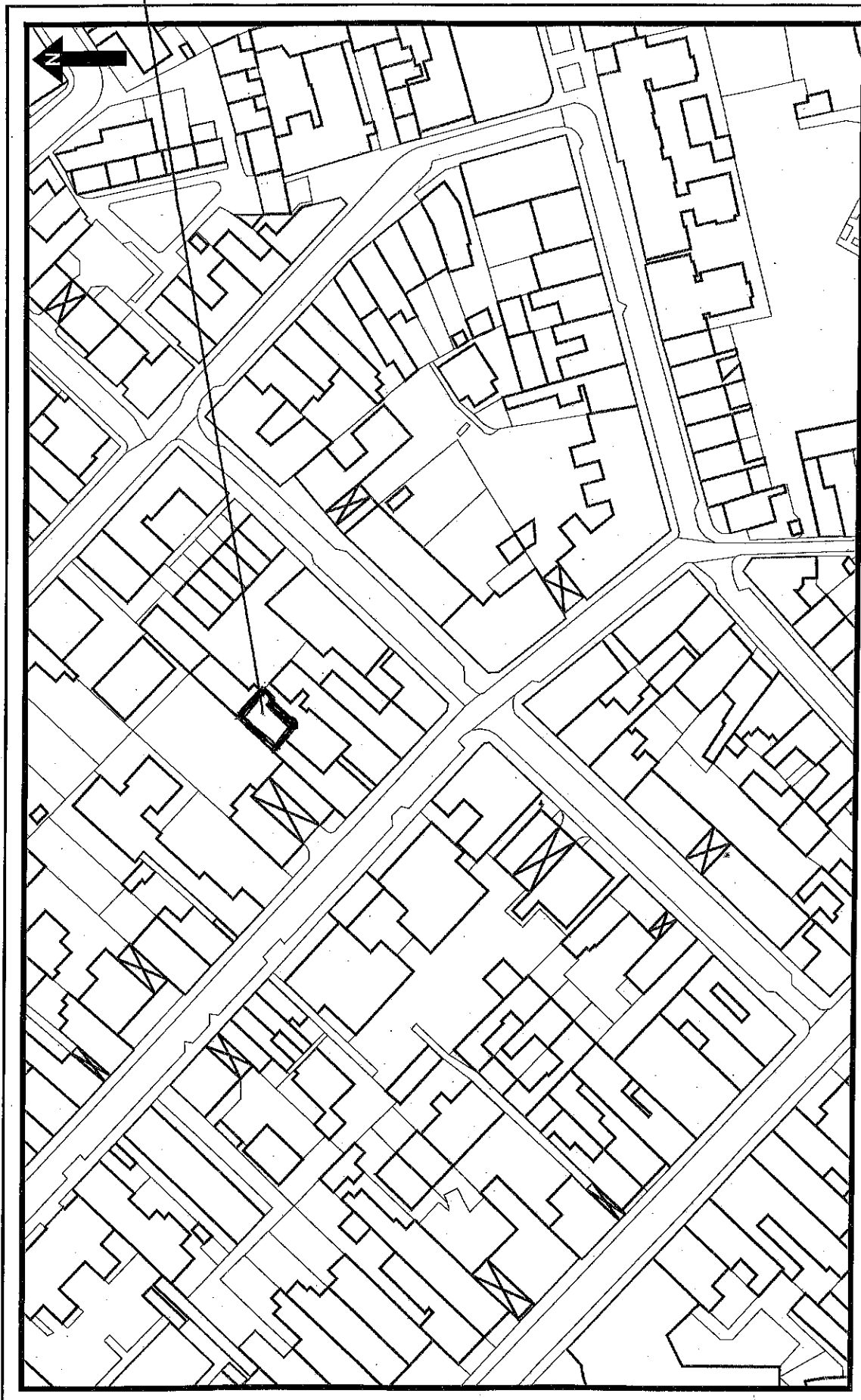

07 February 2018
Scale: 1:1000
mapping@gov.je

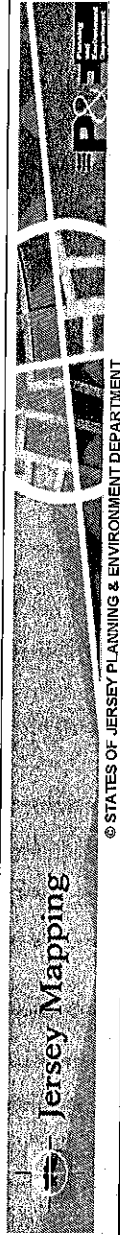

States
of Jersey