

Portions of this document include intellectual property of the States of Jersey and are used herein by permission.
 Copyright © States of Jersey (2006). License No. J2

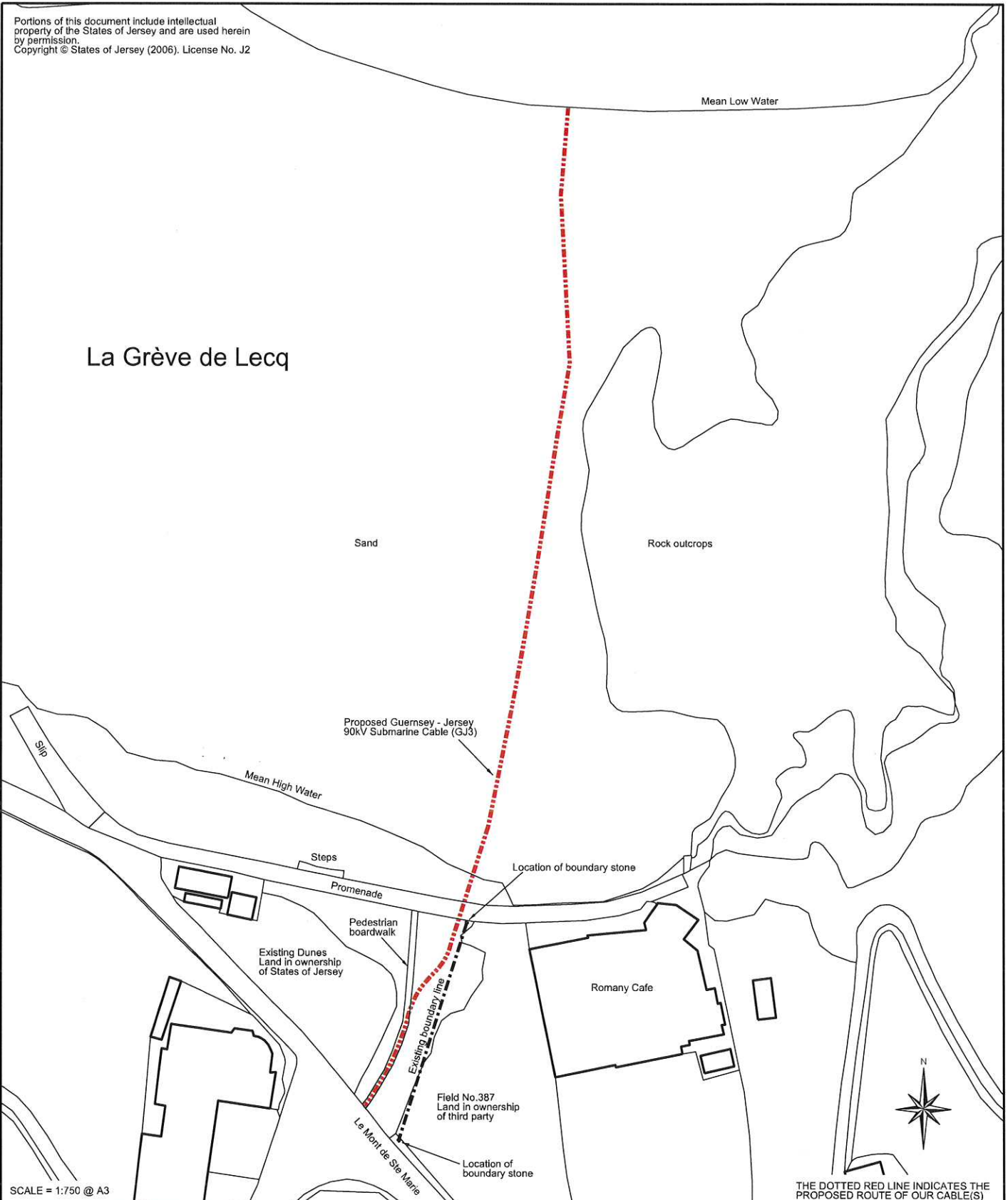

SCALE = 1:750 @ A3

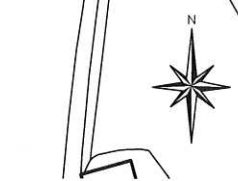

THE DOTTED RED LINE INDICATES THE PROPOSED ROUTE OF OUR CABLE(S)

Rev	Date	Description	Drawn	Acod
A	16-6-2015	Area down to Mean Low Water added	DGB	TB
-	16-4-2015	Original Issue	DGB	TB

Title
**Proposed Guernsey - Jersey
 90kV Submarine Cable (GJ3)**
 Cable Wayleave for
 Greve de Lecq,
 St. Ouen, Jersey.

The Intellectual Property Rights (IPR) in Patents, Copyright, Trade Secrets, Design Rights etc., remain strictly the property of Jersey Electricity Company plc and may not be copied and/or reproduced in any form without their Express Permission.



Jersey Electricity plc

The Powerhouse PO Box 45 Queen's Road St. Helier Jersey JE1 8NY.
 Tel - 01534 505000 Fax - 01534 505011 e-mail - jec@jec.co.uk

Drq. No. **GL-01-009-5** Revision **A**