

Building Bye-Laws (Jersey)

Application for the renovation of a Thermal Element

Please read the general guidance notes on the back of this form before answering all the questions.  
One copy must be completed using block letters. Failure to fully complete this form could result in delays.

**Note: For assistance in completing this application form see accompanying guidance note.**

1. Address of property:

7 OAK COURT, WOODLANDS APARTMENTS	
LA ROUTE DES COTILS	
GROUVILLE	Postcode: JE3 9AW

2. Applicant name and address:

(The person(s) for whom the work is to be carried out)

WOODLAND ESTATES LIMITED	
C/O VOISIN-HUNTER LTD, 31-33 NEW STREET	
ST HELIER	Postcode: JE2 3RA

Applicant contact details:

Tel  
Email

3. Agent name and address:

VOISIN-HUNTER LTD	
31-33 NEW STREET	
ST HELIER	Postcode: JE2 3RA

Agent contact details:

Tel  
Email

4. Proposed commencement date for the work: (If known)

/	/
---	---

5. Description of proposed work:

overlay of existing asphalt roof with new insulated roof system. liquid applied system.

6. Element to be renovated: (e.g. timber roof with slates etc.)

flat asphalt roof

7 (a). Is the element to be renovated currently insulated:

Yes	<input type="checkbox"/>	No	<input checked="" type="checkbox"/>
-----	--------------------------	----	-------------------------------------

(b). If yes, describe type and thickness of insulation and state estimated U-value:

8. Where there is no insulation or where the insulation provides a U-value worse than that shown in the technical notes accompanying this form provide details of the materials to be used to improve the thermal performance of the thermal element:

kingspan tr27 tissue faced board 130mm providing approx .17 U-value

9. To be completed for all applications:

Building application fee  
Map fee  
Total

£
£
£

Cheque number  Debit card (Separate form coded: CCNPT to be completed)

**CHECKLIST – Please check that you have provided the following information:**

1. ☐ 1 original application form fully completed.
2. ☐ 1 copy of the current 1:2500 scale map of the Island showing the site outlined in red.
3. ☐ Fee section completed.
4. ☐ Cheque enclosed and cheque number box completed.

**GUIDANCE NOTES**

- (a) This form is only to be used for the purpose of obtaining building bye-law permission for work involving the renovation of an existing thermal element of a building.
- (b) Guidance on meeting the building bye-law requirements can be found in the supporting technical guidance documents which can be downloaded from the States of Jersey website, [www.gov.je](http://www.gov.je) or purchased from the department.
- (c) EVERY APPLICATION must include one copy of a location map, which is an authorised direct copy of the current 1:2500 scale map of the Island and the appropriate fee for the works.  
The fees payable for applications are set out in the department's fee schedule which can be downloaded from the States of Jersey website, [www.gov.je](http://www.gov.je) or collected from the department.  
Cheques should be made payable to the 'Treasurer of the States'.

**For office use only**

Screened by			Fee checked by				
Further payment required?	Yes	<input type="checkbox"/>	No	<input type="checkbox"/>	Amount	£	
Refund due?	Yes	<input type="checkbox"/>	No	<input type="checkbox"/>	Amount	£	
Return application?	Yes	<input type="checkbox"/>	No	<input type="checkbox"/>			
Fee incorrect	<input type="checkbox"/>	Inadequate plans	<input type="checkbox"/>	Insufficient information	<input type="checkbox"/>	Incomplete form	<input type="checkbox"/>
		East	<input type="checkbox"/>	West	<input type="checkbox"/>		
		Allocate to	<input type="checkbox"/>				

## DECLARATION

### Important information:

Before signing this form please read the following consent information carefully. It explains how your information will be used and provides a brief description of your rights under Jersey's Data Protection Law. For further information on how the Department of the Environment handles personal data please visit [www.gov.je/howweuseyourinfo](http://www.gov.je/howweuseyourinfo)

### Consent of all parties named in this application

I declare that this application is made with my authority. I am aware that it's an offence to submit false or misleading information with an application.

I am aware and agree to the information supplied on this form, together with any other accompanying information, being used for the purpose(s) of assessing this application for a building permit as required under the Building Bye-laws (Jersey) 2007.

I am aware and agree that the information supplied on this form, together with any other accompanying information:

- may be disclosed to other States departments and relevant authorities so that you can consult with them about the suitability of this application
- may be made accessible to members of the public so that they may comment on this application
- may be published in the local media and on the States of Jersey website as the information forms part of the register of building applications which is required by law to be made available

I further understand that as a public authority, you are subject to the provisions of the Freedom of Information (Jersey) Law 2011. Under this Law you may be required to disclose information you hold, including the contents of this form and any other information I provide to you, unless the information is protected from disclosure by an exemption under the Law or any other enactment, including the Data Protection (Jersey) Law 2018

### Your right to withdraw consent:

You have the right to withdraw your consent to the further processing of your information. However, this may cause delays or prevent us delivering a service to you or cause you to be in breach of other legal requirements.

If you would like to exercise this right please contact us on 445508

Applicant Name:		Signature:	Date: 20/2/2020
--------------------	---	------------	--------------------

Applicant Name:		Signature:	Date:
--------------------	--	------------	-------

Owner Name:		Signature:	Date:
----------------	--	------------	-------

Owner Name:		Signature:	Date:
----------------	--	------------	-------

Agent Name:		Signature:	Date:
----------------	--	------------	-------



[REDACTED]

---

**From:** [REDACTED]  
**Sent:** Friday, 28 February 2020 17:42  
**To:** [REDACTED]  
**Subject:** RE: Woodlands

[REDACTED]

I can confirm that a BUR (warm roof) build-up with Centech PU waterproofing is suitable to receive paving on pedestals, however I would advise to install either a separation fleece or that the spacers have rubber soles, this will protect the new waterproofing membrane from any abrasion.

I can also advise that PJJ Construction are a Centaur CQP approved contractor and once works are completed the required guarantees will be issued.

If there is any other information required, please do not hesitate to contact me.

Kind Regards,

[REDACTED]

# Woodland Apartments

## Section through Door

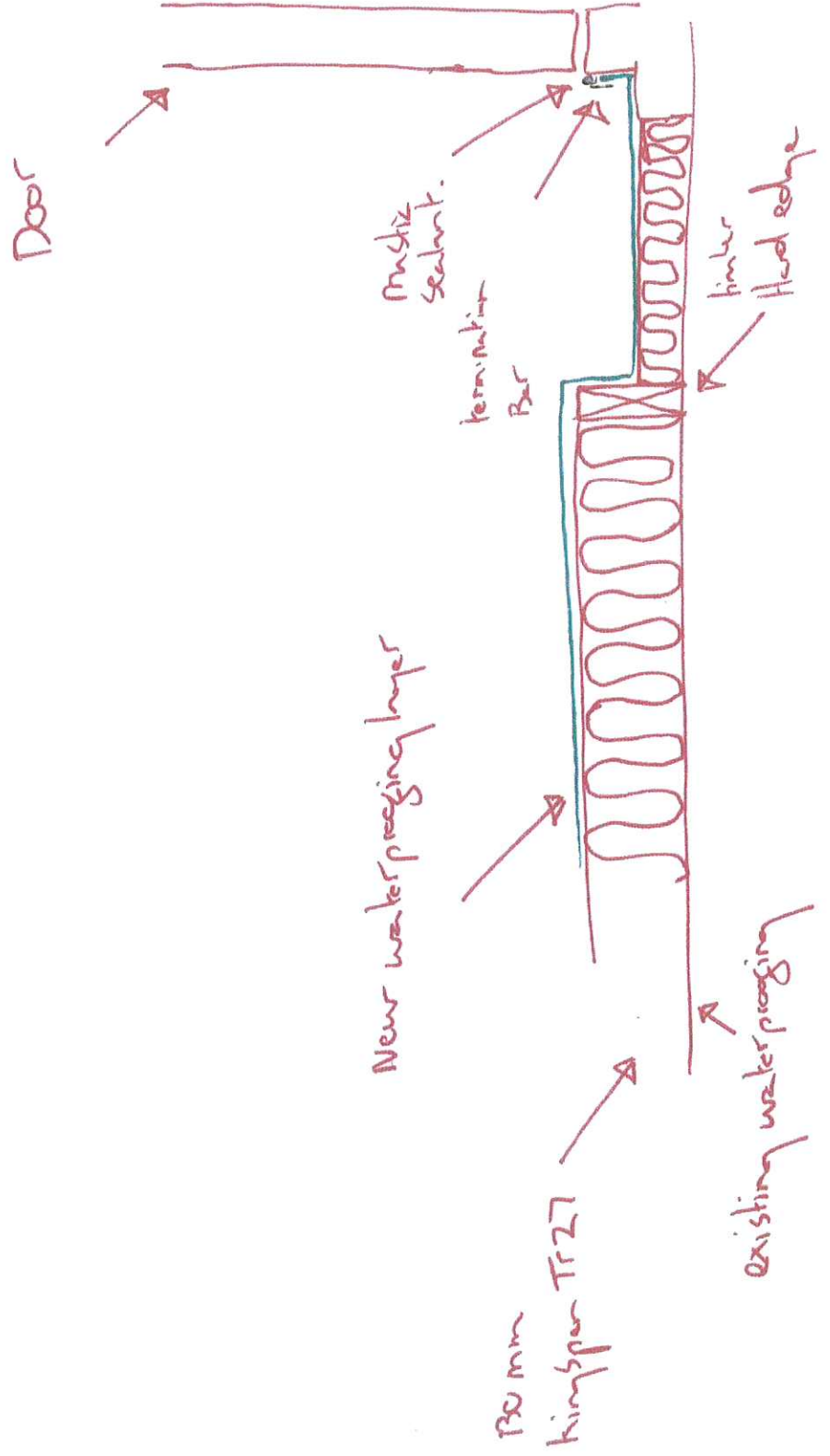

Woodlands.

sls extenders with

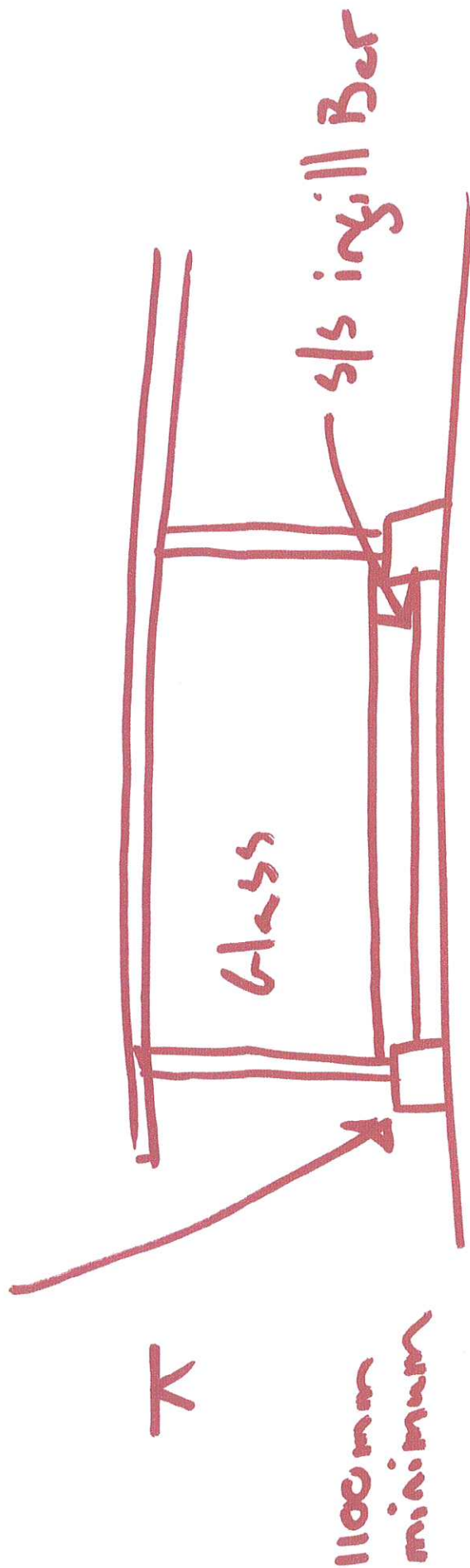

✓

1100mm  
minimum

Existing  
Paving

✓

# Woodward's Apartments

## Section through wall

option B

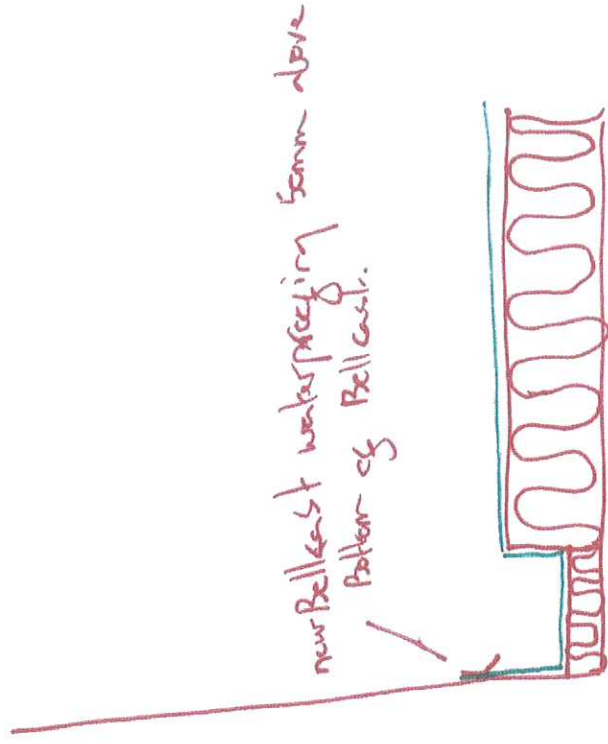

option A

