

NOTES:

1. ALL LEVELS EXCEPT THOSE SHOWN WITHIN LA COLLETTE PHASE 1 ARE SHOWN ABOVE ADMIRALTY DATUM. LEVELS WITHIN LA COLLETTE PHASE 1 ARE SHOWN ABOVE ORDNANCE DATUM.
2. THIS DRAWING IS TO READ IN CONJUNCTION WITH OTHER RELEVANT DRAWINGS AND THE DRAWINGS OR DETAILS OF ANY SPECIALIST DESIGNERS OR SUPPLIERS.
3. INTERNAL FACILITY LAYOUTS ARE SHOWN FOR INDICATIVE PURPOSES ONLY. FOR DETAILED FACILITY LAYOUTS REFER TO DRAWINGS AND INFORMATION FROM RESPECTIVE FACILITY DESIGN CONSULTANTS.

KEY:

- CONSTRUCTION SITE BOUNDARY
 - PLANNING APPLICATION SITE
 - LAND OWNERSHIP
 - LA COLLETTE HAZARD ZONES
 - BIOAEROSOL PROXIMITY ZONE
- SURFACE FINISHES:**
- BITUMINOUS ROAD PAVEMENT
 - UNBOUND BITUMINOUS ROAD PLANINGS
 - CONCRETE PAVEMENT
 - HOGGIN ACCESS TRACK
 - FOOTWAY
- FENCING:**
- 2.0m HIGH JACKSONS EUROGUARD REGULAR FENCE
- VEHICLE & PEDESTRIAN BARRIERS**
- 1.5m HIGH BOLLARD
 - 1.1m HIGH GALVANISED PEDESTRIAN RAILING
 - 0.75m HIGH ARMCO CORRUGATED BARRIER
- DRAINAGE & SERVICES:**
- EXISTING FOUL WATER SEWER
 - EXISTING FOUL WATER MANHOLE
 - EXISTING FOUL WATER GULLY
 - PROPOSED FOUL WATER SEWER
 - PROPOSED FOUL WATER MANHOLE
 - EXISTING SURFACE WATER SEWER
 - EXISTING SOAKAWAY
 - PROPOSED SURFACE WATER SEWER
 - PROPOSED SURFACE WATER MANHOLE
 - PROPOSED CATCH PIT (600 x 600 C/O)
 - PROPOSED SURFACE WATER GULLY
 - PROPOSED SOAKAWAY
 - LIGHTING COLUMN
 - CCTV COLUMN
- METALS RECYCLING FACILITY ABOVE GROUND STRUCTURES:**
1. OFFICE AND WELFARE FACILITIES
 2. WEIGHBRIDGE
 3. STORAGE BUILDING
 4. BUNDED FUEL STORAGE
 5. END OF LIFE VEHICLE DEPOLLUION BUILDING
 6. SERVICES KIOSK
 7. LPG EQUIPMENT

LEVELS:

- EXISTING GROUND LEVEL
- PROPOSED GROUND LEVEL
- BUILDING FINISHED GROUND FLOOR LEVEL

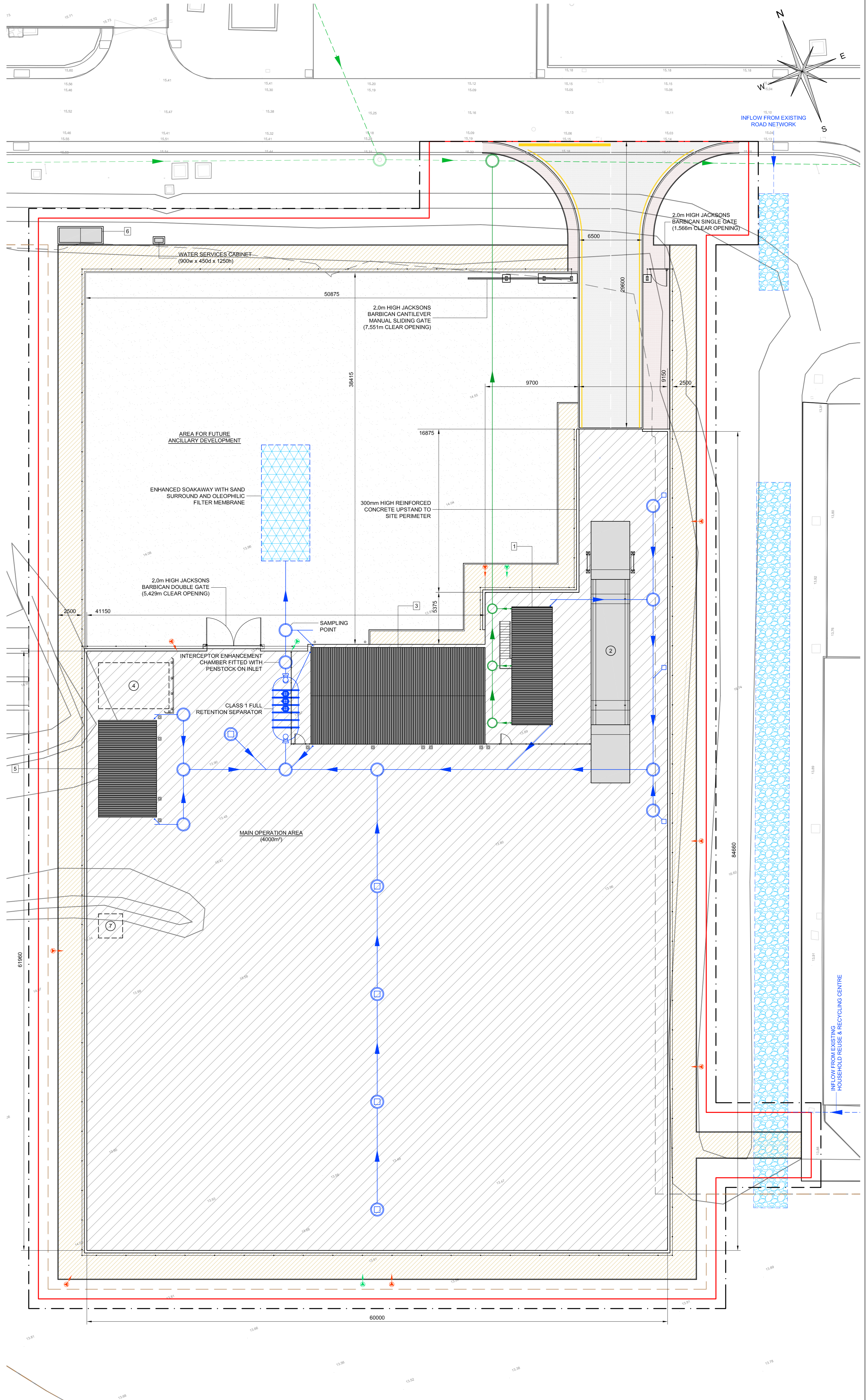

Department for Infrastructure
 States of Jersey
 P.O. Box 412, Beresford House,
 Bellozanne Road, St Helier,
 Jersey, JE4 8UY
 Tel: +44 (0)1534 445509 website: www.gov.je
 Fax: +44 (0)1534 445529 email: DFI@gov.je

Project
 LA COLLETTE
 METALS RECYCLING PARK
 ST HELIER
 JERSEY

Title
 METALS RECYCLING FACILITY
 PROPOSED FACILITY PLAN

Drawn by: OB Checked by: OB
 Scale: 1:200 @ A1 Date: JUL 2016

Drawing No. 201604/100/002 Revision P9

Rev.	Date	Details
P9	15/08/2017	PRELIMINARY - WATER SERVICES CABINET LOCATION ALTERED
P8	07/08/2017	PRELIMINARY - SERVICES HOUSH POSITION ALTERED. WATER SERVICES CABINET ADDED
P7	03/08/2017	PRELIMINARY - OFFICE AND WELFARE FACILITIES AND STORAGE BUILDING POSITION ALTERED. SITE FENCING REMOVED. FACILITY FENCING ALTERED. CCTV COLUMNS ADDED
P6	11/07/2017	PRELIMINARY - STORAGE BUILDING FOOTPRINT REDUCED. BUNDED FUEL STORAGE AREA PERIMETER WALL REMOVED. SURFACE WATER DRAINAGE ALTERED
P5	11/04/2017	PRELIMINARY - FOR PLANNING APPLICATION PURPOSES
P4	15/03/2017	PRELIMINARY - FENCING, FOOTWAY, ACCESS TRACK ALTERED. STORAGE BUILDING POSITION AMENDED. PHYSICAL LOCATION ALTERED TO DOWNSTREAM OF INTERCEPTOR
P3	21/02/2017	PRELIMINARY - ADDITIONAL SURFACE WATER MANHOLE ADDED BETWEEN INTERCEPTOR AND SOAKAWAY. UNBOUND BITUMINOUS ROAD PLANING AREA AND ACCESS TRACK ALTERED
P2	17/02/2017	PRELIMINARY - OFFICE & WELFARE FACILITIES, STORAGE BUILDING, FENCING, ACCESS TRACK AND SOAKAWAYS ALTERED. EXISTING SOAKAWAYS ADDED
P1	20/01/2017	PRELIMINARY - OFFICE & WELFARE FACILITIES, WEIGHBRIDGE AND ENTRANCE ROAD LOCATIONS ALTERED
A	07/07/2016	PRELIMINARY - FOR DISCUSSION AND SIGN-OFF

