

APPENDIX 12



ISLAND DEVELOPMENT COMMITTEE

ISLAND PLANNING (JERSEY) LAW, 1964.
PUBLIC HEALTH (CONTROL OF BUILDING) (JERSEY) LAW, 1956.

Registration No. 4/8/3199-K

Building Plan No.

To R. A. Herve, Esq.,
La Retreat Farm,
ST. LAWRENCE.

The Island Development Committee, having considered your [agent's] application hereby GRANTS PERMISSION in respect of the following development:-

Construction of 98,784 sq. ft. of additional commercial glasshouses together with access track, plant and boiler house and oil storage tank

proposed to be carried out at Northern part of field 770, St. Mary.

in accordance with the plan(s) accompanying the said application, subject to compliance with the following conditions.

1. That the accompanying notices numbered 1 to 6 required to be given under the Building Bye-Laws are given at the appropriate stages of the development, as indicated in the heading of each notice, and that no part of the development is brought into use until it has been inspected and passed by the Building Inspector and the Chief Sanitary Inspector.
2. That the development shall commence within one year of the date of this permit, which shall otherwise cease to be valid.
3. That the whole of the work shown on the plan(s) accompanying the said application shall be completed by 18.8.80.
4. That all surplus soil and material at present stored in the western part of the field is to be removed and the land made good to the reasonable satisfaction of the Island Development Committee.
5. That intensive tree planting and hedging is to be undertaken between the northern boundary of the field and the northern edge of the new access track to the north of the new glasshouses. This planting is to be conducted at the appropriate season of the year and the trees and shrubs are to be maintained and in the event of failure replaced to the reasonable satisfaction of the Island Development Committee.
6. That the permit now granted makes provision for a structure which will include a boiler house and technical equipment and if, in the opinion of the Committee, the operation of any part of that plant or equipment causes unreasonable prejudice to the enjoyment of other property in the vicinity, then the Committee reserves the right to require such remedial action as may be reasonably needed to alleviate any such nuisance.

(A) stamped copy/copies of the plan(s) submitted is/are returned herewith.

Date

18th August, 1978.

R.B. Skinner
Chief Executive Officer

PLEASE READ CAREFULLY THE CAUTION ON THE REVERSE OF THIS PERMIT

section b

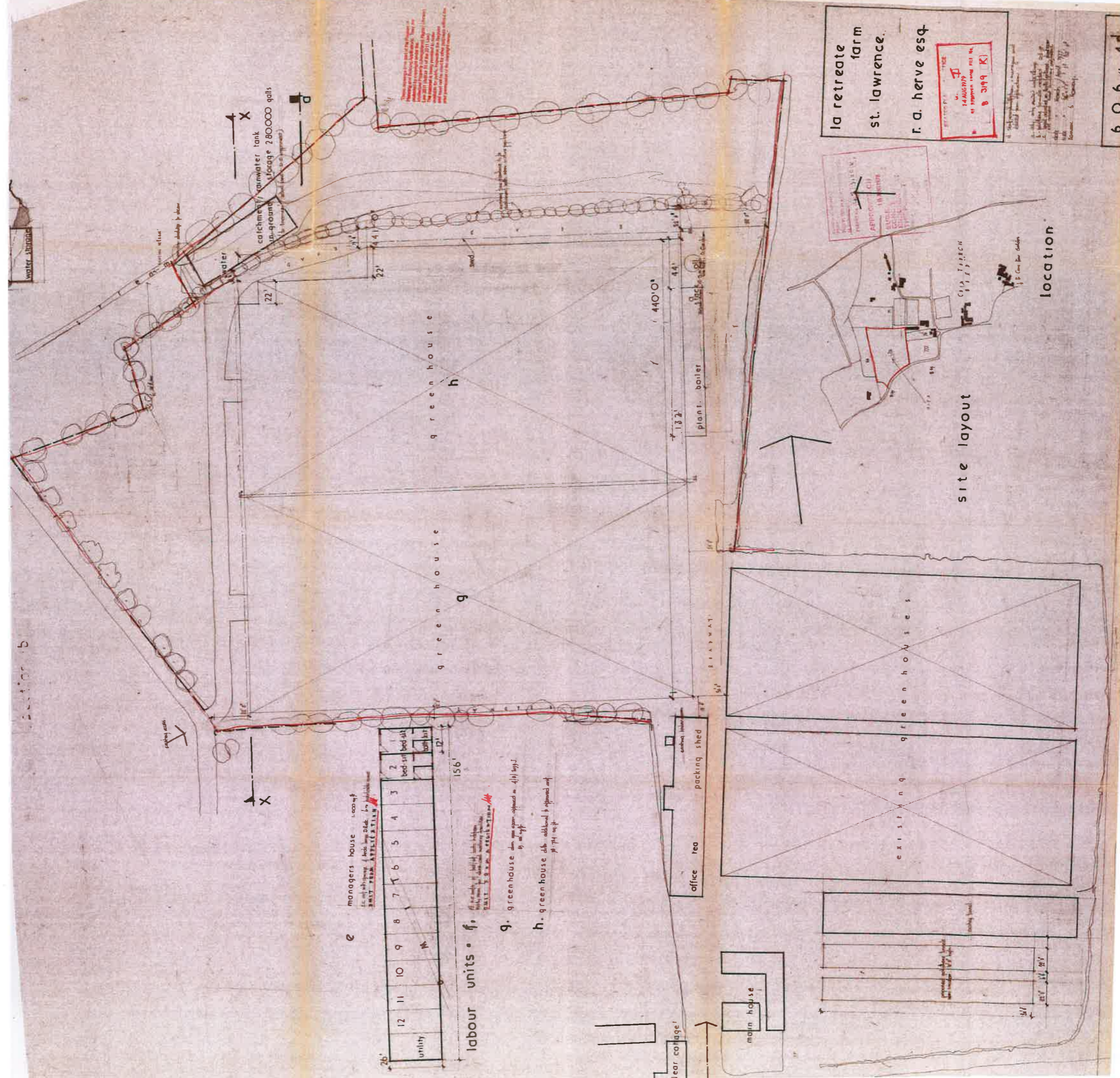

la retraite farm
st. lawrence.
r. d. herve esq.

14 AUGUST 1979
8 3199 (K)

AGRICULTURE
CITY OF PERTH
CITY OF PERTH
CITY OF PERTH

site layout

location

606