JERSEY FUTURE HOSPITAL CO004 – SITE OPTION REPORT

APPENDIX 21 Site Reuse Proposals

QUALITY ASSURANCE

Sign off: Kieren Morgan

Position: Principal

		Ground	First	Second	Third	Fourth	Total
Block 1	Single Bed Apartment	4	4	4	2	0	14
	Two Bed Apartment	2	2	2	0	0	6
	Three Bed Apartment	2	2	2	2	0	8
Block 2	Single Bed Apartment	4	4	4	4	0	16
	Two Bed Apartment	4	4	4	4	0	16
	Three Bed Apartment	0	0	0	0	0	0
Block 3	Single Bed Apartment	4	4	4	2	0	14
	Two Bed Apartment	2	2	2	0	0	6
	Three Bed Apartment	2	2	2	2	0	8
Block 4	Single Bed Apartment	4	4	4	4	4	20
	Two Bed Apartment	2	2	2	2	2	10
	Three Bed Apartment	0	0	0	0	0	0
Block 5	Single Bed Apartment	4	4	4	4	4	20
	Two Bed Apartment	2	2	2	2	2	10
	Three Bed Apartment	0	0	0	0	0	0
Block 6	Single Bed Apartment	4	4	4	4	2	18
	Two Bed Apartment	2	2	2	0	0	6
	Three Bed Apartment	2	2	2	2	2	10
Block 7	Single Bed Apartment	4	4	4	4	2	18
	Two Bed Apartment	2	2	2	0	0	6
	Three Bed Apartment	2	2	2	2	2	10
Block 8	Single Bed Apartment	4	4	4	4	2	18
	Two Bed Apartment	2	2	2	0	0	6
	Three Bed Apartment	2	2	2	2	2	10
Block 9	Single Bed Apartment	4	4	4	4	2	18
	Two Bed Apartment	2	2	2	0	0	6
	Three Bed Apartment	2	2	2	2	2	10
Block 10	Single Bed Apartment	4	4	4	4	2	18
	Two Bed Apartment	2	2	2	0	0	6
	Three Bed Apartment	2	2	2	2	2	10
Block 11	Single Bed Apartment	2	2	2	2	0	8
	Two Bed Apartment	2	2	2	2	2	10
	Three Bed Apartment	2	2	2	2	2	10
Block 12	Single Bed Apartment	1	1	1	0		3
	Two Bed Apartment	3	3	3	2	2	13
	Three Bed Apartment	0	0	0	0		0
TOTAL UNITS		86	86	86	66	38	362
Total 1 bed apartment		185					
Total 2 bed apartment		101					
Total 3 bed apartment		76					

- Single bedroom apartment approx. 42sq.m
- Two bedroom apartment approx. 63sq.m
- Three bedroom apartment approx. 95sq.m
- Common horizontal circulation
- Common vertical circulation

- 1. Possible additional access through purchase of part of Waterboard site.
- 2. Proposed parking zone

SECTION A-A



1:1000@A3

HASSELL

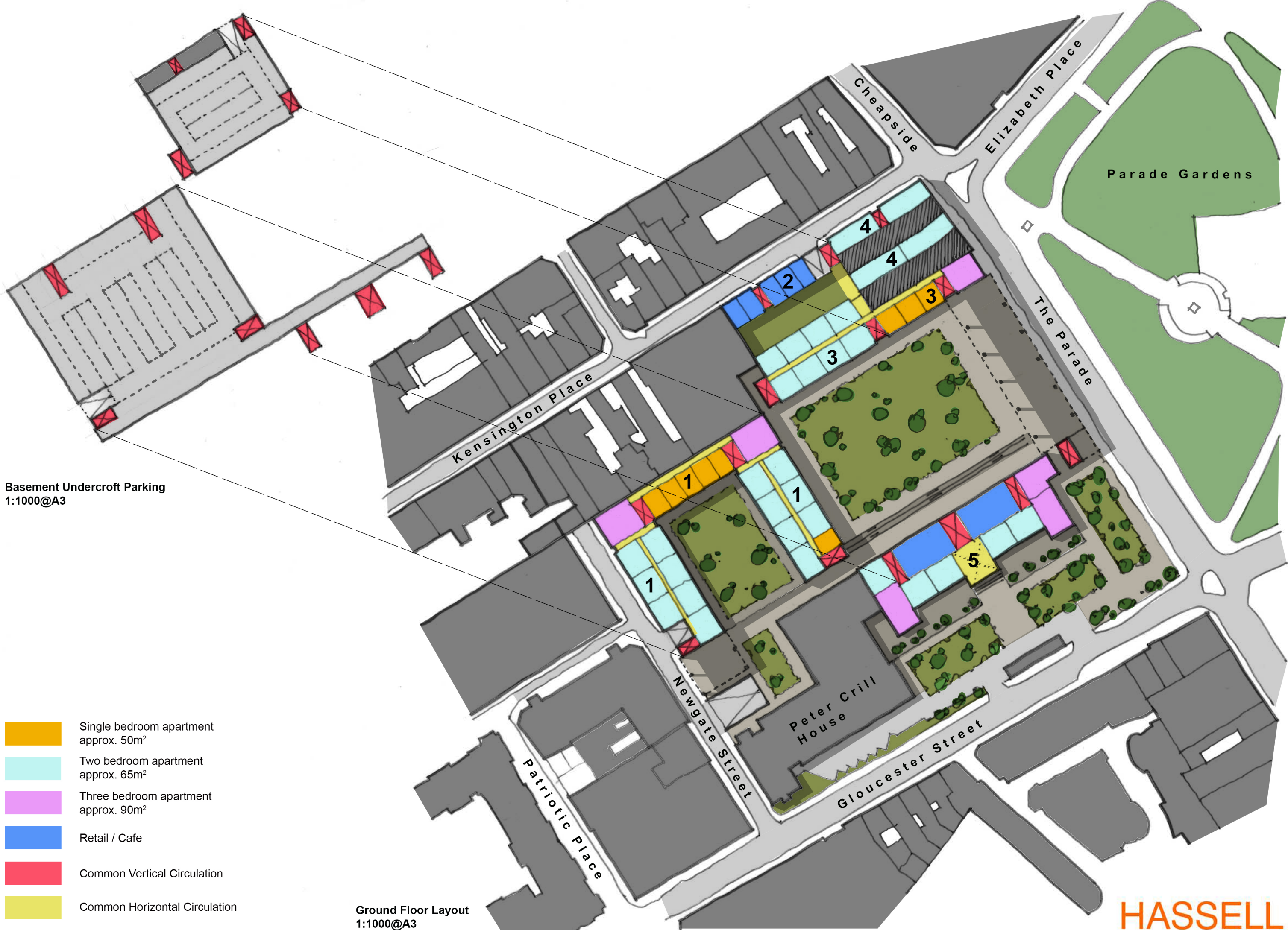

Basement Undercroft Parking
1:1000@A3

- Single bedroom apartment
approx. 50m²
- Two bedroom apartment
approx. 65m²
- Three bedroom apartment
approx. 90m²
- Retail / Cafe
- Common Vertical Circulation
- Common Horizontal Circulation

Ground Floor Layout
1:1000@A3

Block 1 (9 storeys)
78 single bed apartments
126 two bed apartments
29 three bed apartments

Block 2 (7 storeys)
18 three bed apartments

Block 3 (6 storeys)
18 single bed apartments
48 two bed apartments
6 three bed apartments

Block 4 (3 storeys)
12 two bed apartments

Block 5 (4 storeys)
19 two bed apartments
15 three bed apartments

Block 6 (13 storeys)
33 single bed apartments
44 two bed apartments
44 three bed apartments

TOTAL

138 single bed apartments
263 two bed apartments
112 three bed apartments

513 Total No. of Units

- Single bedroom apartment
approx. 50m²
- Two bedroom apartment
approx. 65m²
- Three bedroom apartment
approx. 90m²
- Common Vertical Circulation
- Common Horizontal Circulation



Typical Upper Floor Layout
1:1000@A3