

Building Application No. B/2017/0201/
Compliance Case No. ENF/2019/00005

ENFORCEMENT NOTICE

PLANNING AND BUILDING (JERSEY) LAW 2002

- 1. This Notice** is issued pursuant to the powers conferred under Article 40 of the Planning and Building (Jersey) Law 2002 because it appears that a breach of development controls has occurred at the land stated below. Article 33(1) of the above Law states that a person who undertakes prescribed building work except with, and in accordance with, permission in accordance with the Building Bye-laws shall be guilty of an offence.

This Notice relates to land at: **Unit 1, Field No. J1007, La Grande Route de St. Jean, St. John, JE3 4FN**, shown edged by a bold black line on the attached plan.

- 2. The Breach of Building Controls:** Conditions 1, 2 and 3 attached to the building permit referenced B/2017/0201 issued in respect of proposed alterations to part of the ground floor at Unit 1, Field 1007, to create a food preparation station, have not been satisfactorily discharged.
- 3. The reason for serving this Notice:** To remedy the breach of the conditions subject to which building permission to undertake works to create the food preparation station was granted.
- 4. You are hereby required to:**
 - Provide an installation and commissioning certificate for the fire alarm system that has been installed in the food preparation part of the building. That certificate to be produced in accordance with all relevant recommendations of British Standard 5839-1 Code of practice for system design, installation, commissioning and maintenance.
 - Provide an installation and commissioning certificate for the escape lighting that has been provided in the food preparation part of the building. That certificate to be produced in accordance with all relevant recommendations of British Standard 5266-1 Emergency lighting. Code of practice for the emergency lighting of premises.

- c. Provide an installation and commissioning certificate for the mechanical ventilation system that has been installed in the food preparation part of the building. That certificate to be produced in accordance with all relevant recommendations of The Chartered Institution of Building Services Engineers (CIBSE) Guide B2.
5. **Period of compliance:** 21 days after the issue of this Notice.
6. **What will happen if this Notice is not complied with:** If you fail to comply with this Notice, you may be liable to prosecution under the appropriate Article of the Planning and Building (Jersey) Law 2002 for undertaking building work without the benefit of building permission as well as failing to comply with an Enforcement Notice.
7. **Your rights of appeal:** In accordance with Article 109 of the above Law, you may appeal against the Notice, in writing to the Greffier no later than the end of the period of 28 days beginning with the date of issue of the Notice. The date of the issue of the Notice shall be taken as the date stated below.

S 

On this Date: 3-6-19.

For and on behalf of the Chief Officer

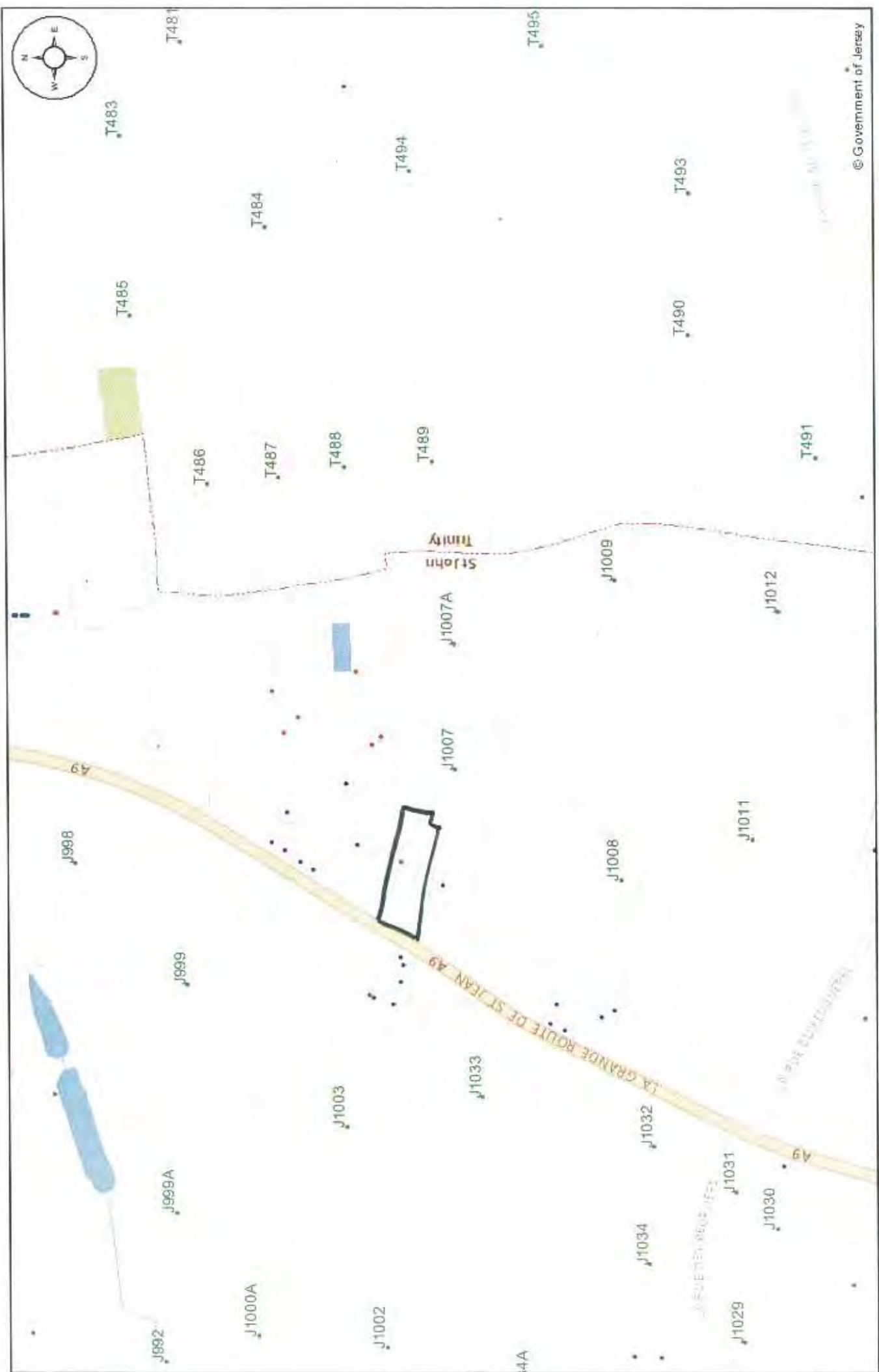

© Government of Jersey



Location Plan

SCALE 1:4,513.99

360 Meters

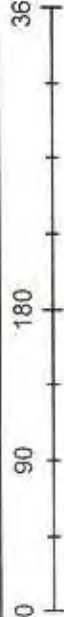

Date: 05/06/2019