

ROOF AREA COLLECTED IN GUTTERS
ON NORTH AND SOUTH ELEVATIONS
DRAIN TO SOAKAWAY

DUAL SKINNED AND
SELF-BUNDED OIL TANK TO
CONTAIN SPILLAGES DURING
FILLING OPERATIONS

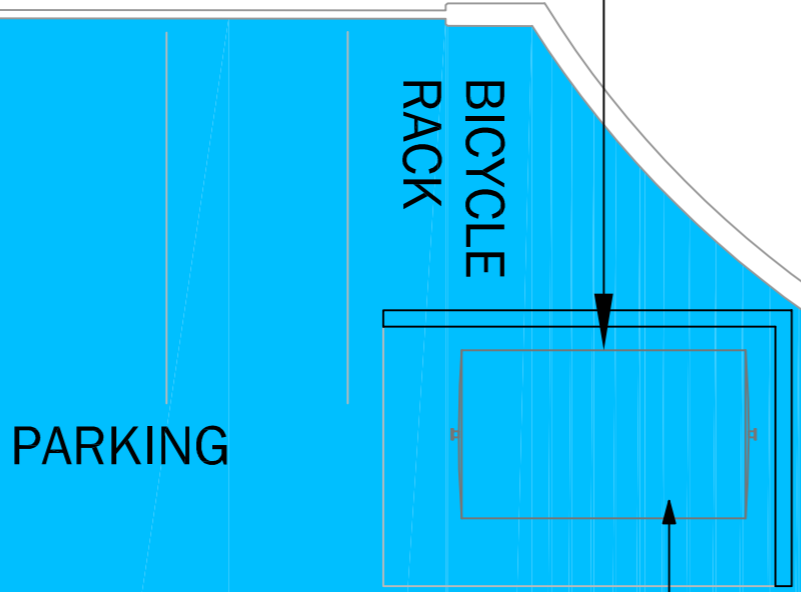

PARKING

EXISTING DFI
11000/433V
SUBSTATION

PERMEABLE AND FREE DRAINING
FINISH DETAIL (GRAVEL FINISH)
(SHOWN IN CYAN)

IMPERMEABLE FINISH DETAIL
THROUGHOUT ENTIRE BUILDING
(200mm THICK RC INTERNAL SLAB)
DRAINING TO FOUL CONNECTION
(SHOWN IN RED)

CONCRETE HARD STANDING

IMPERMEABLE FINISH DETAIL
(200mm THICK RC EXTERNAL
SLAB) DRAINING TO BURIED
SOAKAWAY
(SHOWN IN BLUE)

2.000m HIGH PALLISADE
SECURITY FENCING

EXISTING PLAN

Drg. No. 10566/WML/003 (1)

NOTES

Rev	Date	Ints	Details	CHKD
11	28/01/2018	TLG	WML APPLICATION/ISSUE	GD

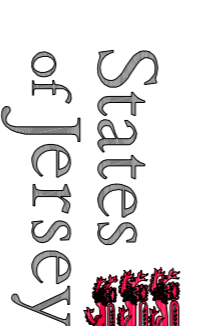

DEPARTMENT FOR
INFRASTRUCTURE

Project
CLINICAL WASTE INCINERATOR
LA COLLETTE
ST. HELIER, JERSEY

Title
WASTE MANAGEMENT LICENCE
DRAINAGE LAYOUT

Drawn by: TLG Project Manager: S. FISHER

Designed by: TLG Approved by: S. FISHER

Checked by: G. DAVIES Date: 24 January 2018

Scales 1 : 100 @ A1

Drg. No. 10566/WML/003 (1)