

THIS DRAWING AND ALL DESIGN AND DETAILS ARE THE COPYRIGHT OF CHANNEL ARCHITECTS LTD.
 This drawing must be read in conjunction with all other drawings, details and specifications issued by the Architect, Structural Engineer and other Consultants or approved specialists. Discrepancies between any other drawings, details and/or specifications must be referred to the Architect for verification at least 7 days prior to commencement of the work. It is the Contractor's responsibility to ensure all work is carried out in accordance with all statutory requirements and to the approval of the Building Control Officer. All roof decking or external plywood to be W.B.P. bonded external grade. All materials to comply with the latest British Standards Specification or have an Agrément Certificate. The Contractor is responsible for all setting out of the works. Use written dimensions only, do not scale off drawings. All dimensions and setting out must be checked on site. If in any doubt refer to the Architect prior to commencement of the work.

REVISIONS

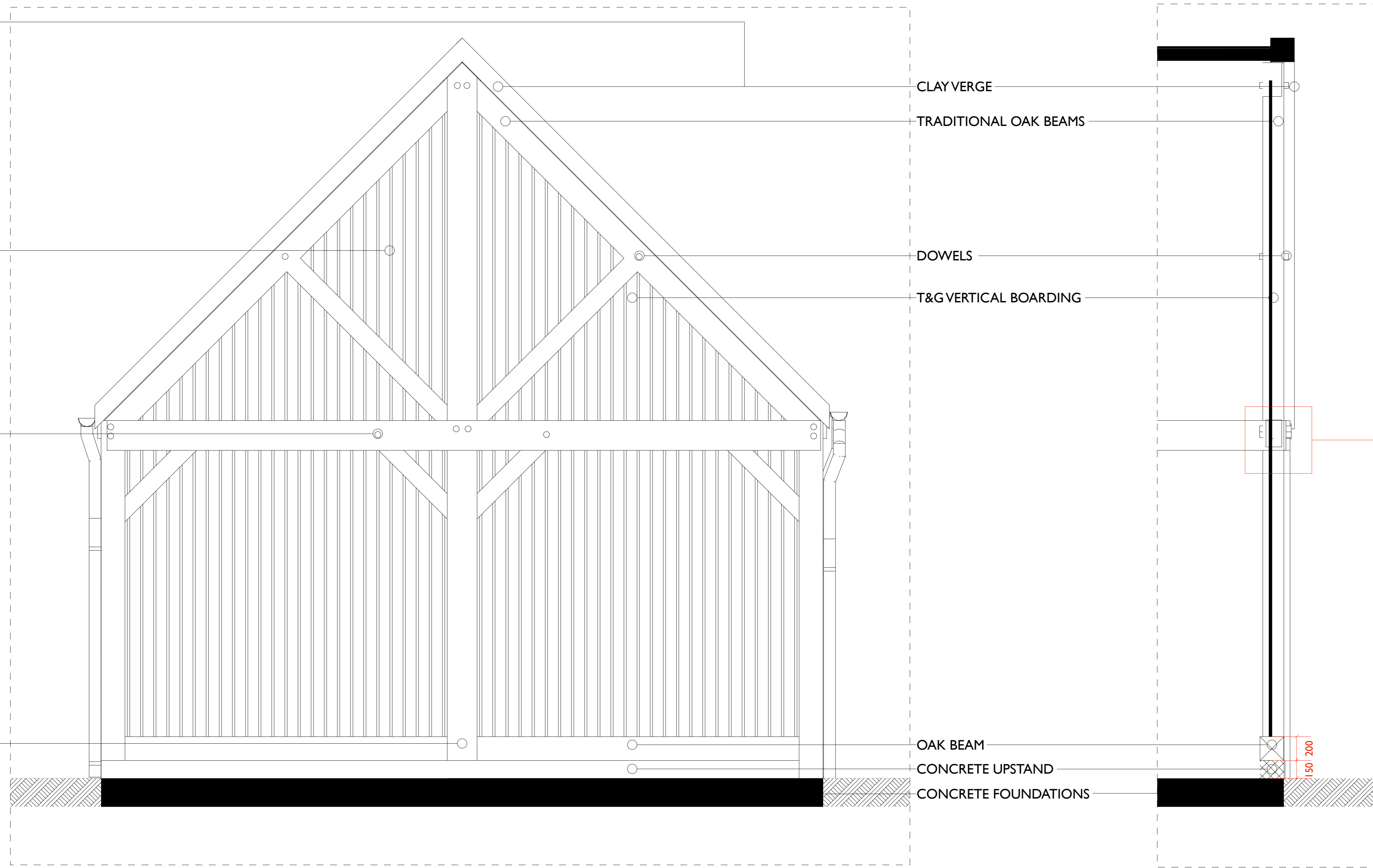

ABOVE: Precedent structure for oak pegged mortise and tenon joinery. With the weight of the structure concentrated on the frame, the interior remains largely open and unobstructed.



CART SHED GABLE ELEVATION

1:20

CART SHED SECTION DETAIL

1:20

BELOW: Precedent joinery method; oak beams & dowels

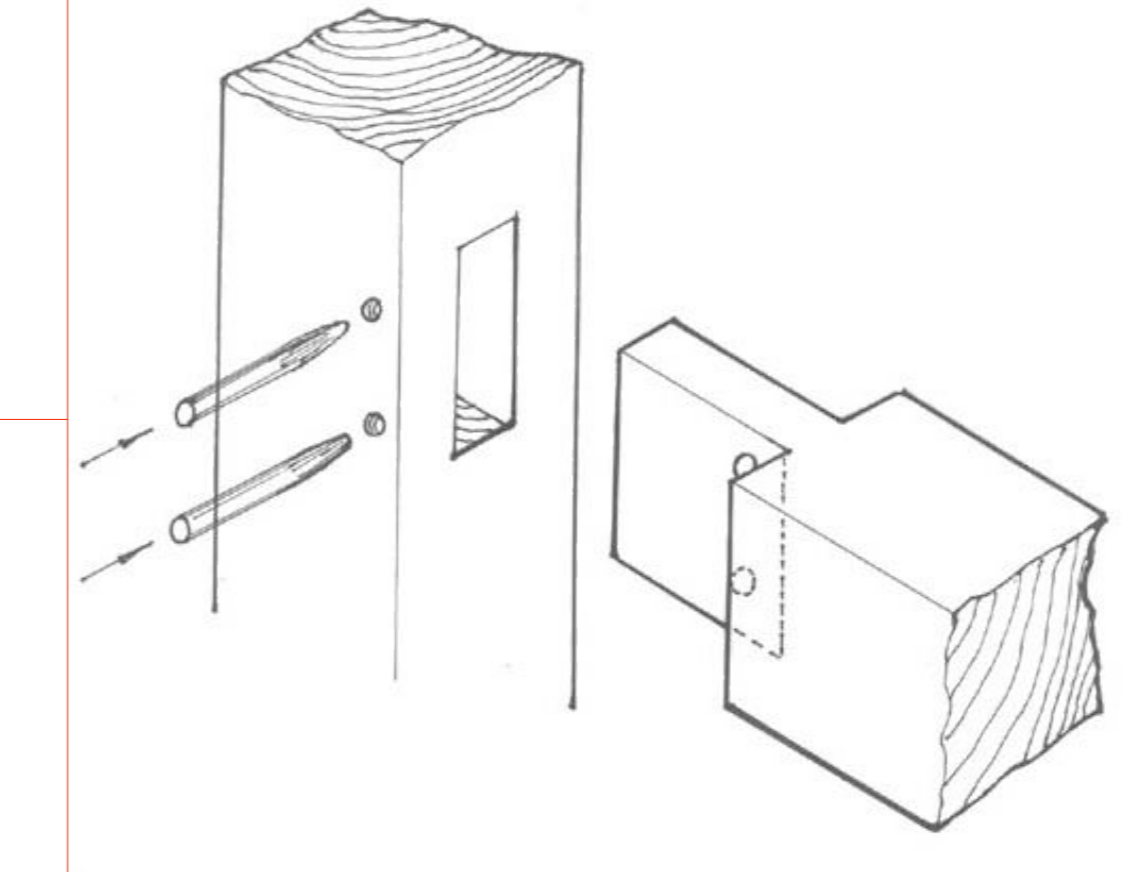

MATERIAL	IMAGE
TRADITIONAL BLUE/GREY SLATE (ROOF)	
TERRACOTTA TILE (VERGES)	
TREATED TIMBER (T&G BOARDING)	
TREATED TIMBER (FEATURE BEAMS & DOWELS)	
PAINTED T&G BOARDING (GARAGE DOORS & INFILLS)	

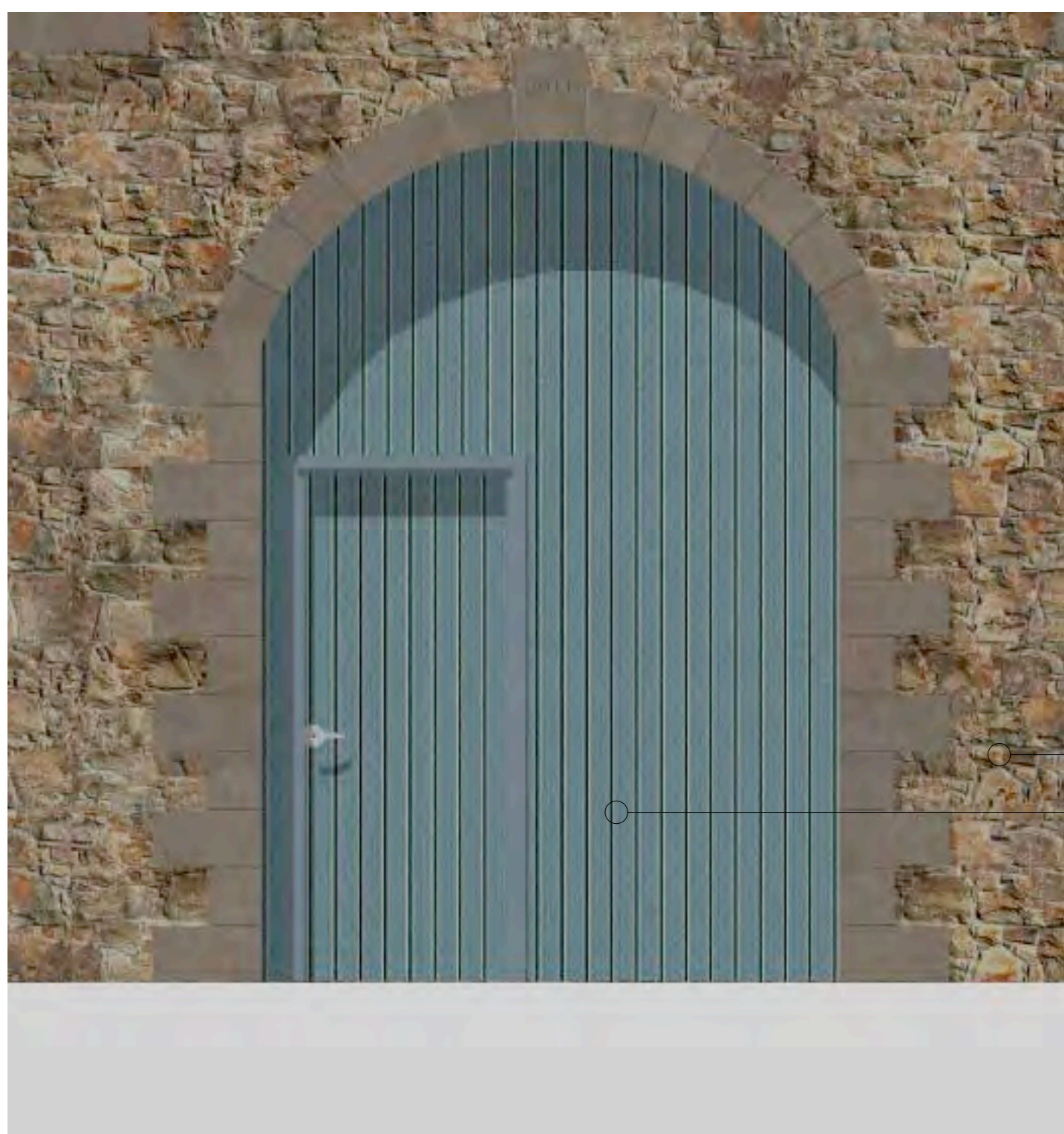

ROUGHLY DRESSED GRANITE
PAINTED T&G BOARDING INFILL

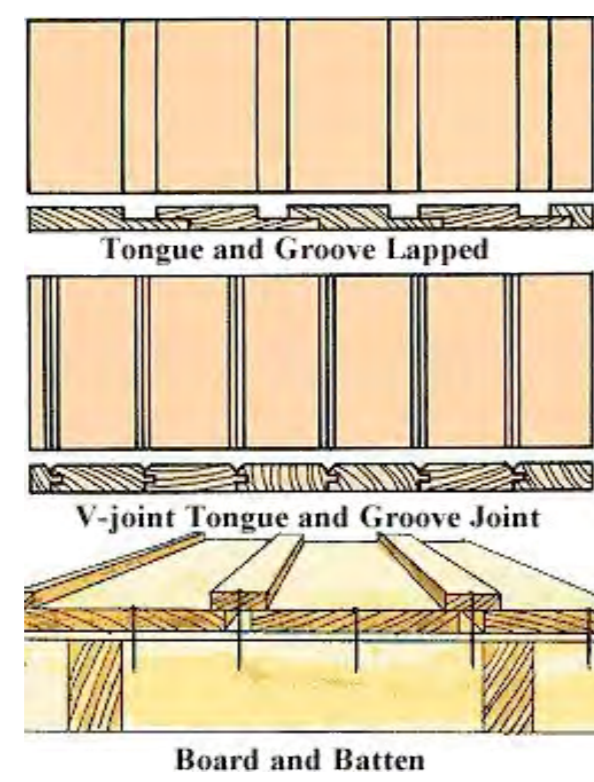

ASIDE: Precedent methods; tongue & groove panels, boarding and battens

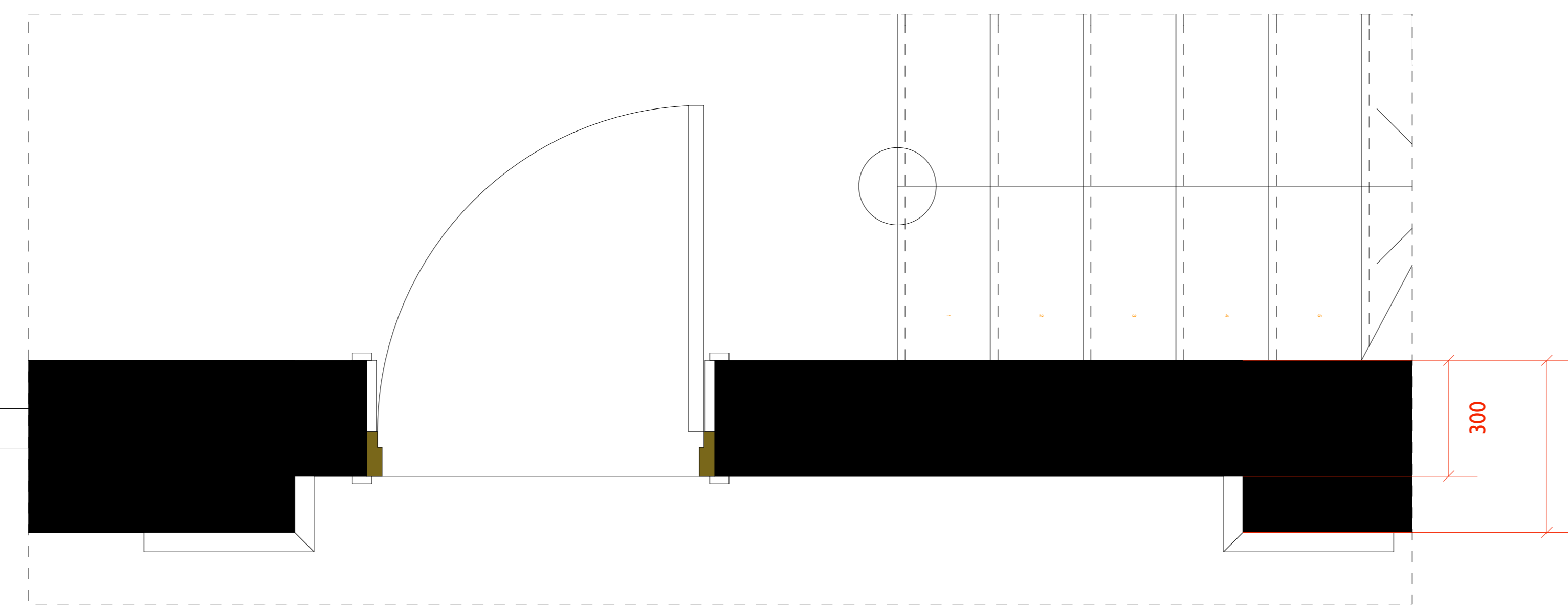

ARCH INFILL DETAIL

1:10

PLANNING APPLICATION

B D K Architects
 White Lodge,
 Wellington Road,
 St. Saviour,
 JERSEY
 Channel Islands
 JE2 7TE
 Tel: +44 1534 768740
 Fax: +44 1534 739115
 E: Enquiry@BDKArchitects.com



PROJECT / LOCATION		DRAWING	
PLEMONT BAY HOLIDAY VILLAGE PLEMONT 28 HOUSES DEVELOPMENT		TYPICAL 'CART SHED' & WOOD FINISH DETAILS	
CLIENT	PLEMONT ESTATES LTD	DRAWN	CHECKED
DATE	JUNE 2010	SB	PH
SCALE	1:20 / 1:10 @ A0	DRAWING NUMBER	1871/P/04