

Compliance Case No. ENF/2015/00014

STOP NOTICE

PLANNING AND BUILDING (JERSEY) LAW 2002

1. **This Notice is served upon:** [REDACTED]
2. **This Notice** is issued pursuant to the powers conferred under Article 45 of the Planning and Building (Jersey) Law 2002 because it appears that there has been a breach of development controls and that it is expedient that an activity constituting, or forming part of, that breach should cease.
3. **This Notice relates to land at: Gibraltar Farm, Le Mont des Vignes, St. Peter, Jersey, JE3 7BD**, shown edged by a bold black line on the attached plan.
4. **Activity to which this Notice applies:** Significant excavation works next to Gibraltar Farm.
5. **The reason for serving this Notice:** It appears that the above breach of development controls has occurred within the last 8 years and that an activity or activities are being carried on that constitute or form part of that breach. It is considered expedient that the activity or activities cease, due to the serious harm caused to the landscape character of the area, contrary to policy NE7 of the Island Plan
6. **You are hereby required to cease all the activity specified in this Notice immediately.**
7. **This Notice takes effect on the date of issue of this Notice.** The date of issue shall be taken as the date stated below.
8. **This Notice**, if not sooner withdrawn, shall cease to be valid 7 days after its service if an Enforcement Notice or additional Stop Notice is not served within those 7 days, or if an Appeal is made against the Notice.
9. **What will happen if this Notice is not complied with:** If you fail to comply with this Notice, you may be liable to prosecution under the appropriate Article of the Planning and Building (Jersey) Law 2002.

Department of the Environment
Planning and Building Services

South Hill
St Helier, Jersey, JE2 4US
Tel: +44 (0)1534 445508
Fax: +44 (0)1534 445528
www.gov.je



10 Your rights of appeal: In accordance with Article 109 of the above Law, you may appeal against the Notice, in writing to the Greffier no later than the end of the period of 28 days beginning with the date of issue of the Notice. The date of the issue of the Notice shall be taken as the date stated below.



SIGNED:
2015

On this Date: 5th August

For and on behalf of the Chief Officer

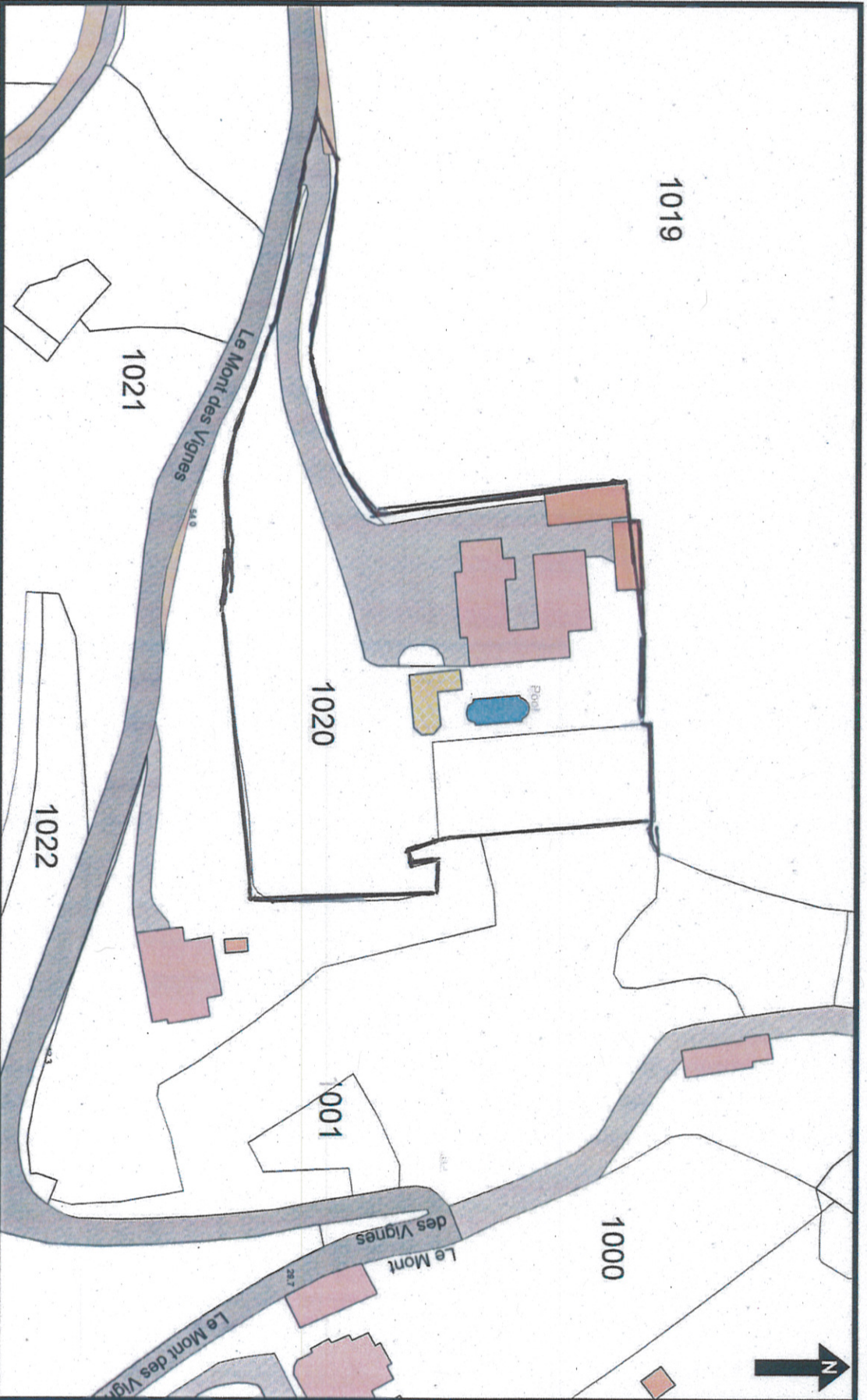

05 August 2015
Scale: 1:1000
mapping@gov.je

Jersey Mapping

© STATES OF JERSEY PLANNING & ENVIRONMENT DEPARTMENT

States of Jersey